

Wall-mount Basin Faucet Installation Instructions

Single handle wall-mount basin faucet

Model:

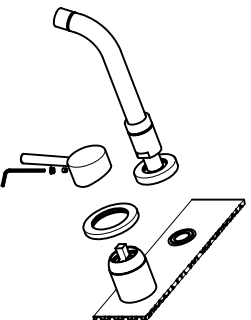
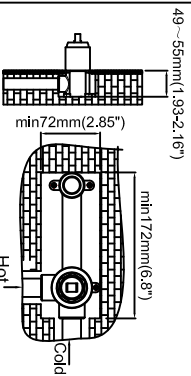

1. The wall opening Min size of the main valve body is 172*72mm(6.8*2.85") and the depth is 49~55mm(1.93~2.16"). Note: The depth dimension is the size of the tile after the wall is finished. If installing on the wall embryo, please reserve the appropriate tile thickness.
2. After installing the main valve body, the water to be tested is completed, and the pipeline and the main valve body can be covered after confirming that there is no leakage.

Two handle wall-mount basin faucet

Model:

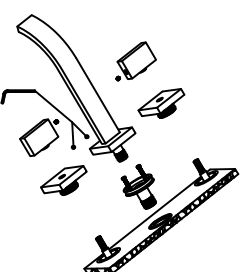
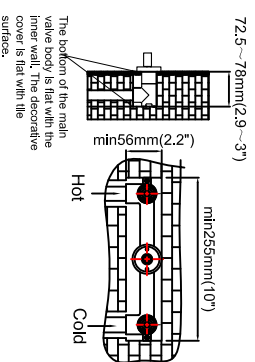
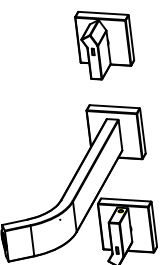

1. The wall opening Min size of the main valve body is 255*56mm(10*2.2") and the depth is 72.5~78mm(2.9~3"). Note: The depth dimension is the size of the tile after the wall is finished. If installing on the wall embryo, please reserve the appropriate tile thickness.
2. After installing the main valve body, the water to be tested is completed, and the pipeline and the main valve body can be covered after confirming that there is no leakage.

Two handle wall-mount basin faucet

Model:

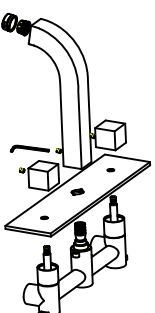
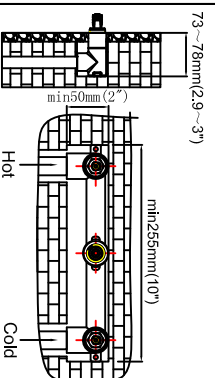
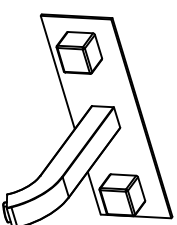

1. The wall opening Min size of the main valve body is 255*50mm(10*2") and the depth is 73~78mm(2.9~3"). Note: The depth dimension is the size of the tile after the wall is finished. If installing on the wall embryo, please reserve the appropriate tile thickness.
2. After installing the main valve body, the water to be tested is completed, and the pipeline and the main valve body can be covered after confirming that there is no leakage.

Single handle wall-mount basin faucet

Model:

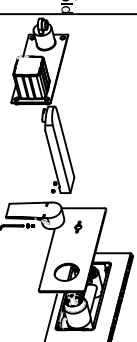
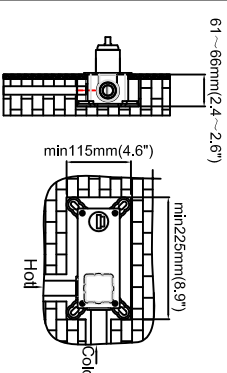
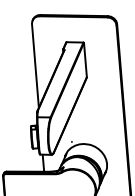

1. The wall opening Min size of the main valve body is 225*115mm(8.9*4.6") and the depth is 61~66mm(2.4~2.6"). Note: The depth dimension is the size of the tile after the wall is finished. If installing on the wall embryo, please reserve the appropriate tile thickness.
2. After installing the main valve body, the water to be tested is completed, and the pipeline and the main valve body can be covered after confirming that there is no leakage.

Two handle wall-mount basin faucet

Model:

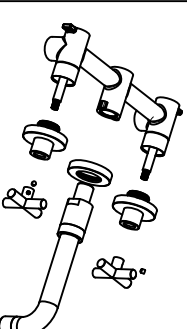
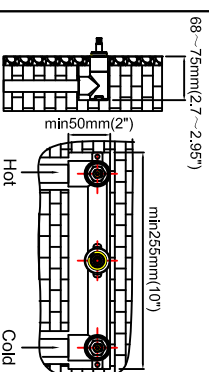
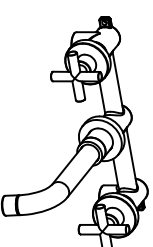

1. The wall opening Min size of the main valve body is 255*50mm(10*2") and the depth is 68~75mm(2.7~2.95"). Note: The depth dimension is the size of the tile after the wall is finished. If installing on the wall embryo, please reserve the appropriate tile thickness.
2. After installing the main valve body, the water to be tested is completed, and the pipeline and the main valve body can be covered after confirming that there is no leakage.

